



You are invited to attend the next Traffic Committee Meeting:

Date: Tuesday, 10 December 2019
Time: 14:00
Location: Council Chamber
62-64 Menangle Street
Picton NSW 2571

AGENDA

Traffic Committee Meeting

10 December 2019

The Local Traffic Committee is a Technical Committee of Roads and Maritime Services (RMS). The Committee operates under the authority conferred to Council by the RMS under the Transport Administration Act 1988.

Council has been delegated certain powers from the RMS, with regard to traffic matters upon its local roads. A condition of this delegation is that Council must take into account the Traffic Committee recommendations.

There are four permanent members of the Traffic Committee, each of whom has a single vote only. The members are representatives of the NSW Police Force, the RMS, the Local State Member of Parliament (for the location of the issue to be voted upon) and a representative of Council.

Order Of Business

1	Reports	4
1.1	Proposed give way (R1-2) sign and associated linemarking improvements on Tylers Road, Bargo	4
1.2	Thirlmere Festival of Steam 2020 Road Closures	8
2	General Business	23
2.1	Douglas Park Drive Slope Stabilisation Work and Temporary Road Closure.....	23

1 REPORTS

1.1 PROPOSED GIVE WAY (R1-2) SIGN AND ASSOCIATED LINEMARKING IMPROVEMENTS ON TYLERS ROAD, BARGO

File Number: 10623#88

EXECUTIVE SUMMARY

- It is recommended that Council approve the installation of a Give Way (R1-2) sign on Tylers Road at the intersection with Remembrance Driveway and an extension of the BB lines to the intersection of Silica Rd, Bargo.

REPORT

Council recently endorsed the LTC recommendation for the newly constructed pedestrian refuge island crossing and its associated line marking on Tylers Rd, Bargo.

Upon further inspection of the site, it has been found that the existing length of S1 line on Tylers Rd between the intersection of Remembrance Driveway and Silica Rd is too short and does not conform to design standards. It is proposed to replace this short section of S1 lines with BB line marking. In addition, it would be appropriate to formalise the T junction at Remembrance Driveway with a Give Way (R1-2) intersection control to increase safety for vehicles exiting Tylers Road onto Remembrance Driveway.

Consultation

This issue has not been raised and discussed in a Community Forum.

Financial Implications

Funding has been allocated and is available under vote 4402-5210-3627.

Attachments

1. Design Plan No. X2973 Drawing No. 7 & Locality Map

RECOMMENDATION

That Council approve the installation of a formal Give Way (R1-2) junction control on Tylers Rd at Remembrance Driveway and associate line marking, and the replacement of the existing S1 line with BB line on Tylers Rd from the intersection of Remembrance Driveway to Silica Rd, Bargo.



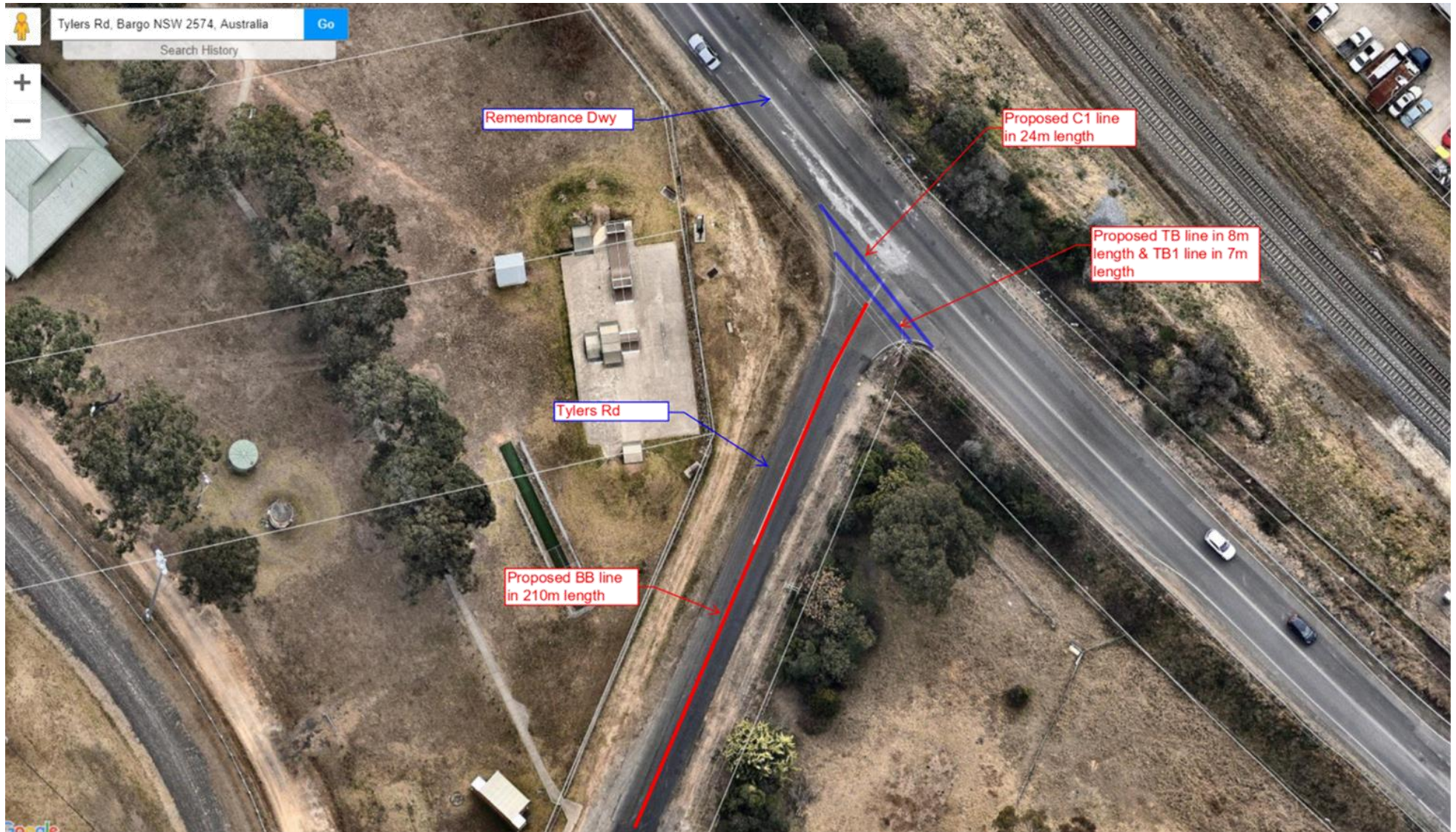

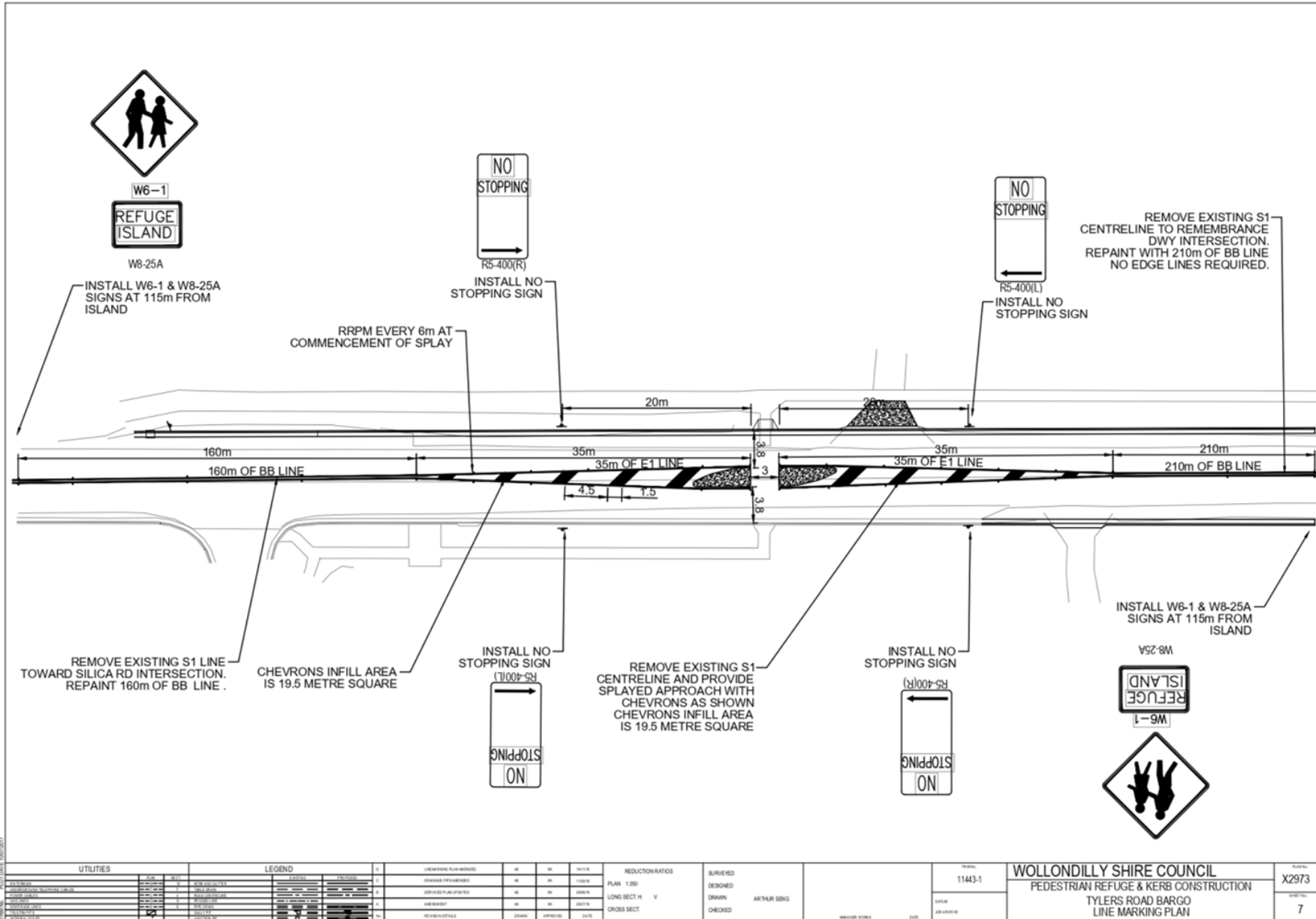

1.2 THIRLMERE FESTIVAL OF STEAM 2020 ROAD CLOSURES

File Number: 10623#89

EXECUTIVE SUMMARY

- It is recommended that Council approve the temporary road closure of various roads in Thirlmere on Sunday 1st March 2020 for the Thirlmere Festival of Steam event.

REPORT

The organising Committee for the Thirlmere Festival of Steam has asked for permission to close several roads for the Thirlmere Festival of Steam event to be held on Sunday 1st March 2020. As a preventative measure to hostile mobile vehicles (HMV) it is proposed that all road closure locations will have water filled barriers installed.

The road closures are proposed from 6.00am till 5.00pm on Sunday 1st March 2020 at the following locations:

1. Oaks Street - between the roundabout and Carlton Road
2. Barbour Road - between Oaks Street and Lakes Street
3. Mason Street - between Barbour Road and Goodlet Street
4. Westbourne Avenue – between North Street and Oaks Street
5. Close St - between Barbour Rd and Campbell St (proposed to be used for accessible parking up to Barbour Road & at the Sportsground off Goodlet St.)

North Street will be one way from Westbourne Avenue to Carlton Road.

In addition, the closure of Goodlet Street and a small section of Oaks Street between Goodlet St and Carlton Rd will be implemented for 30mins only at 1.00pm for the traditional street parade.

The closures proposed are the same as those arranged for the 2019 event.

Consultation

This annual event has involved the participation of local stakeholders through the organising committee.

Financial Implications

This matter has no financial impact on Council's adopted budget or forward estimates.

ATTACHMENTS

1. Letter of Request from The Rotary Club of Picton
2. Traffic Management Plan (incl site plans) and Traffic Control Plan

RECOMMENDATION

That council approve the temporary closure of various roads in Thirlmere as listed in this report, between the hours of 6.00am and 5.00pm on Sunday 1st March 2020 for the staging of "Thirlmere Festival of Steam 2020" subject to the requirements for the issue of a permit for "Road Event – Road Closure".



Rotary



Barbour Road Thirlmere NSW 2572
 PO Box 25 PICTON NSW 2571
 Telephone: 0484 132 060
www.thirlmerestivalofsteam.com

Email: thirlmerestivalofsteam@pictonrotary.com.au

11 November 2019

Mr Ben Taylor
 Chief Executive Officer
 Wollondilly Shire Council
 P O Box 21
 Picton NSW 2571

cc: Michael Malone

WOLLONDILLY SHIRE COUNCIL
 TRIM NO. 1836-3
 PROP. No.
 21 NOV 2019
 AUTH. No.
 ASSIGNED TO: C Yam

ABN: 22 953 610 241

WOLLONDILLY SHIRE COUNCIL
 CHOONG YAM
 20 NOV 2019
 RECEIVED AT COUNTER
 BY _____

Dear Ben,

Proposed Temporary Road Closures – Thirlmere Festival of Steam 2020

Once again, and following the success of the Thirlmere Festival of Steam in March this year, thanks in no small way to the support of Council, we have re-established our organising committee for next year's festival. The committee includes local business and other interested people from Wollondilly generally, appropriate in view of the contribution of the wider Wollondilly Shire and the significance of the event in the shire overall - not just Thirlmere.

The existing Festival of Steam committee members are delighted to continue in their roles and will work alongside the new committee members from the Thirlmere business community and interested locals to present another successful event for the Wollondilly Shire on Sunday 1st of March 2020.

Obviously there are some organisational matters that need to be attended to, including application for the necessary temporary road closures in Thirlmere for the event, to be held on Sunday 1 March 2020.

We therefore apply for Council's permission to close roads in Thirlmere, between 6:00 a.m. and 5:00 p.m., to facilitate the events of the festival and ensure the safety of the many visitors the day attracts, as follows:

- Oaks Street between the railway station roundabout and Carlton Road
- Mason Street from Barbour Road to Goodlet Street
- Close St from Barbour Rd to Campbell St- disabled parking will be provided up to Barbour Rd & at the sportsground off Goodlet St.
- Barbour Road between Oaks Street and Lakes Street
- Westbourne Avenue from North Street to Oaks Street
- North Street will be one way from Westbourne Ave to Carlton Rd

In addition, as in all past years, we seek approval to close Goodlet Street and the very short section of Oaks Street between Goodlet Street and Carlton Road, for 30 minutes only at 1:00 pm, for the conduct of the traditional street parade.

The closures proposed are the same as those arranged for the 2019 Steam Festival.

We will comply with the conditions set by Council for the closures, including:

- Police concurrence;
- publication of a notice in local newspapers giving notice and details of the closures and detours, at least seven days prior to the event;
- erection of signs detailing the closures at all entrances to Thirlmere;

- advice to affected residents and businesses by means of a letterbox drop;
- advice to local bus operators;
- advice to emergency services including Rural Fire Service, NSW Ambulance Service, Police and NSW Fire Brigade
- maintenance of emergency access for affected residents and emergency services;
- manned road closure barriers inc Water barriers as Hostile Vehicle Mitigation measures.
- submission of a Traffic Control Plan prepared by a suitably qualified person (attached)
- submission of a Transport Management Plan addressing wider transport issues such as parking, etc (attached)
- public liability insurance cover (\$20 million).

We understand from the police that our arrangements for traffic control and our Transport Management Plan were very satisfactory, and we intend to maintain and improve in these areas for 2020.

Yours sincerely,

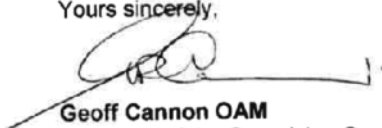

Geoff Cannon OAM
Chairman of the Organising Committee
The Rotary Club of Picton
0431 434 417



**TRAFFIC MANAGEMENT PLAN
THIRLMERE FESTIVAL OF STEAM 2020**



As at 6.11.19

Traffic Management Plan

Project:
Thirlmere Festival of Steam 2020



Document No:TMP0333019

REVISION				
REV	DESCRIPTION	DATE	APPROVED	
A	2017 plan	18/8/16	WSC LTC	
1.1	Review	25/2/17	WSC LTC	
1.2	Final TMP 2018	6/10/17	Shannon Thomas	
2.1	TMP 2019	1.9.2018	Peter Fist	
2.1	TCP 2019	1.9.2018	Shannon Thomas	
2.2	TCP & TMP	6.11.2019	Traffic logistics	

Issuer:

**Picton Rotary
NSW Rail Museum**

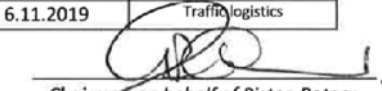
Chairman on behalf of Picton Rotary
Geoff Cannon



**TRAFFIC MANAGEMENT PLAN
THIRLMERE FESTIVAL OF STEAM 2020**



Contents

Table of Contents

Pg.	
1.0	Purpose
2.0	Scope
3.0	References
4.0	Responsibilities
5.0	Proposed Strategy for Traffic Management
5.1	Hostile Vehicle Mitigation Measure
5.2.	Road Closures and Detours
5.3	Festival Parade
5.4	Transport Issues Park & Ride Service
6.0	Access to Local Properties
7.0	Pedestrians / Disabled
8.0	Off Street Parking
9.0	Public Transport – Park & Ride Scheme
10.0	Sensitive Places
11.0	Community / Motorist Notification
12.0	Emergency Vehicles
13.0	Timing of the event including set up & pack up
14.0	Traffic Controllers
15.0	OHS & R
Pgs 10,11	Park & Rides stops, Locality & Town maps
Pg 12	Traffic Control Plan – Traffic Logistics P/L



TRAFFIC MANAGEMENT PLAN THIRLMERE FESTIVAL OF STEAM 2020



1.0 Purpose

The purpose of this Traffic Management Plan (TMP) is to ensure that by documenting a considered approach to local road closures for the 2020 Thirlmere Festival of Steam will cause minimal impact in the public domain for all the non-festival going public.

This year's Thirlmere Festival of Steam organised by BD Productions in partnership with Rotary Club of Picton and the NSW Rail Museum will be centred in the Village of Thirlmere, encompassing the historic Thirlmere Railway Station. Centred at the roundabout, on Oaks St. The footprint extends along Barbour Rd and Westbourne Ave north/south between Lake St and North St and along Oaks St east / west between Goodlet St to Thirlmere Way. Temporary Road closures will be in place on Sunday 1st March 2020. Road Closure details are explained further within the relevant Traffic Control Plan.

It is anticipated in excess of 16,000 people will attend the event this year.

Thirlmere Festival of Steam is classified as Class 2 Event under the RMS Guide to Traffic & Transport Management for Special Events V3.2 – 2006.

2.0 Scope

This document will discuss the impact of road closures and detours necessary for public safety at the event. Extended parking and shuttle bus service is being scoped for event 2020 to further improve the event and lessen the impact on Thirlmere community.

We anticipate that iconic locomotive 3801 **MAY** be on site for display only but as this will not be the launch NSW Rail Museum do not believe that there will be a huge increase in attendance as a direct result of this display.

The NSW Rail Museum will be limiting ticket sales to enter the museum to 4000 and will be presold.

Consideration is given to;

- Minimising the traffic impact on the non-event community including emergency services.
- Isolation of the event space from traffic.
- Necessity to reroute generalised traffic.
- Managing the reduced capacity of the roadway.
- Compliance with OH&S Act 2000 (Traffic Control Plan).
- Minimising cost to the Wollondilly Shire Council.

3.0 References

RTA's (RMS) Traffic Control at Worksites Manual V4

Australian Standard AS1742.3-2009

Austrroads Guide to Traffic Management

RTA's (RMS) Guide to Traffic & Transport Management for Special Events V3.2 – 2006

Acknowledgement; Local Government Guide to; Road Closures, Street Parties and Special Events 1997.

Australian National Security – Australia's Strategy for Protecting Crowded Places from Terrorism - 2017

Australian National Security – Hostile Vehicle Guidelines for Crowded Places - 2017

4.0 Responsibilities

It is the responsibility of the Rotary Club of Picton to ensure that these traffic measures are disseminated, implemented and maintained in accordance with the principles in the project, Occupational Health, Safety and Rehabilitation Management Plan.



TRAFFIC MANAGEMENT PLAN THIRLMERE FESTIVAL OF STEAM 2020



5.0 Proposed Strategy for Traffic Management

To ensure the safety of all event participants it is deemed necessary to close the designated festival area to all but emergency vehicle access. This will involve the implementation of lawful temporary road closures as detailed in this document. The closures will be implemented in two stages.

Stage one where the road closures are implemented with access only for emergency vehicles, council vehicles, local resident traffic egress & ingress, amusement rides and Stall Holders. This stage is called 'Bump In' and will commence from 6am and close at 8am.

Stage two when implemented all non-essential vehicles are removed from the festival site, ready for the pedestrian traffic officially commencing at 9am.

Detailed below are the measures to be undertaken for public notification including emergency services. It should be noted for terrorism reasons mandated the use of water filled jersey kerbs to reinforce the road closed barriers. These jersey kerbs are to be installed on the roadway only and be set in such a way to allow for the movement of emergency vehicles with the assistance of traffic controllers.

5.1 Hostile Vehicle Mitigation Measures.

The Thirlmere Festival of Steam is assessed as being a Low Risk event, as no prior incidents have occurred and no threats received.

Hostile vehicle mitigation measures to be applied to the event are :-

- To use uniformed traffic ticketed RFS officers to man each road closure point.
- Apply standard road closure signage on Road Barriers.
- Use water barriers at each road closure point, placed in a manner to deter hostile vehicle access but still allow access for emergency service vehicles.

5.2 Road Closures and Detours

It is necessary to close to general traffic;

- Oaks Street between the railway station roundabout and Carlton Road
- Mason Street from Barbour Road to Goodlet Street
- Close St from Barbour Rd to Campbell St- disabled parking will be provided up to Barbour Rd & at the sportsground off Goodlet St.
- Barbour Road between Oaks Street and Lakes Street
- Westbourne Avenue from North Street to Oaks Street
- North Street will be one way from Westbourne Ave to Carlton Rd

The closures are the same as those arranged for the 2019 Steam Festival. These times have been set in place with the Police and have worked well.

The road closures and traffic diversions are managed by an accredited WSC Council Representative (Prepare a Work Zone Traffic Management Plan) by means of a Traffic Control Plan prepared especially for the Festival by a qualified traffic management firm.



TRAFFIC MANAGEMENT PLAN THIRLMERE FESTIVAL OF STEAM 2020



5.3 Festival Parade

As part of the Thirlmere Festival of Steam, a Street Parade is held. Short term control measures are also required for the street parade which commences at 1.00pm for half an hour.

The street parade is to assemble within the road closure area in Westbourne Ave near St Stephens Anglican Church. It is to enter the Festival from Westbourne Ave, turn right up Oaks St and turn left into Goodlet St. Walking participants will turn right into the Sportsground from there they will disperse on the oval (away from parking area). Vehicles will turn right into Carlton Rd & return to display area on Westbourne Ave via North St.

The road closures and traffic diversions are managed by means of a Traffic Control Plan prepared especially for the Festival by a qualified traffic management firm. Traffic diversions will also be overseen by a WSC qualified Traffic Manager.

5.4 Transport issues

Shuttle buses will provide a "Park & Ride" service from Tahmoor railway station and from parks/grounds identified as additional parking areas for festival goers (pending advice from Council about which grounds /townships may be available)

6.0 Access to Local Properties

During the Thirlmere Festival of Steam vehicle access to most properties will not be permitted in the interest of public safety. Under Emergency or special circumstances access may be granted on identifying themselves to traffic controllers at the detour points and following risk evaluation of pedestrian safety.

7.0 Pedestrians / Disabled

Full pedestrian access to Festival areas will be maintained. Existing street access ramps are well placed for prams and the disabled. There is an allocated disabled parking, drop off and pick up area as identified in the TCP.



TRAFFIC MANAGEMENT PLAN THIRLMERE FESTIVAL OF STEAM 2020



8.0 Off-street parking

Parking is a major issue, as most patrons come to the Festival by car. Large numbers of cars are parked along the roads surrounding the village of Thirlmere outside the closed road area. There is only a very small amount of dedicated off-street parking in Thirlmere, and the areas that are available – the carpark west of the Sports Ground near the greyhound track and the small carpark associated with the shopping centre in Westbourne Avenue – are impacted by the Festival, either being used for events or Festival features, or relatively isolated by being within the closed road area.

It is estimated that approximately 3,000 cars are parked in and around Thirlmere on the day. Thirlmere Sports Ground can provide off-street parking. This can provide approximately 550 car spaces. In 2019, approx 550 cars were parked in this location, with the arrangements managed by a local service organisation charging a modest fee.

Festival organisers have hired, on a commercial basis, the apron area of Thirlmere Sports Ground to provide off-street parking. There is other off-street car parking area west of the sports ground near the dog track, this is required for parking of stallholders' vehicles (approx. 180).

Tahmoor Pony Club, Tahmoor Sportsground land on Thirlmere Way Tahmoor, vacant land in Marion St Thirlmere and free parking in Picton are under discussion with Council currently and we will provide confirmation of arrangements as it comes to hand.

We will advise Council Traffic Team as arrangements are confirmed.

For 2020 the utilisation of the new overflow parking areas will be further improved by the provision of additional publicity and also extra directional parking signs in the town to promote the off-street site and indicate the location.

9.0 Public Transport - Park & Ride scheme - 2020

Park & Ride service will provide shuttle bus services from Tahmoor Railway Station and lands nominated for overflow parking. They will pick up and drop off at Tahmoor Railway Station and Thirlmere Station. The service will be continuous all day, with the maximum possible service frequency, and the timetable developed to provide the best service possible tailored to meet with NSW Trainlink services.

Substantial parking is available at Tahmoor Station and in Tahmoor township.

Tahmoor Pony Club &/or Tahmoor Sportsground parking will be confirmed to Council as soon as possible.

The existing Tahmoor Station shuttle bus will pick up from this location if approved by Council for use.

Picton Village (in its entirety) & Picton Railway Precinct offers free parking.

A further 2 shuttle buses are planned for event 2020 to transfer visitors from Picton Village at St Anthony's School & Railway Station and to pick up from Tahmoor Railway Station at Tahmoor Pony Club parking areas.

We will provide a shuttle from Picton Station which also picks up in front of St Anthony's school on Menangle St.

Park & Ride stops are shown on the town maps following. Signs indicating Park & Ride for the Thirlmere Festival of Steam will be provided at each stop, along with a copy of the timetable when confirmed.

We will also increase the level of promotion of the scheme and use the Festival's web-site and other promotional



TRAFFIC MANAGEMENT PLAN THIRLMERE FESTIVAL OF STEAM 2020



10.0 Sensitive Places

There is a place of worship, operating within the precinct of the Festival. Vehicle access is denied, during hours of road closure, unless prior arrangements have been made. There are no preschools or other sensitive places impacted in the area. In 2019 Sunday Service was moved to 5pm to ensure public safety & we anticipate this will occur again for 2020.

11.0 Community / Motorist Notification

To ensure awareness of the event and the changed traffic conditions the community will be notified through the local press, letter box drops, event signs, festival website, social media and other media.

Commencing Friday February 21, trailer mounted Variable Message Signs (VMS) will be used to advise motorists of road closures and changed conditions on Sunday March 1st .

The location of these VMS boards will be;

- 1) Thirlmere Way Thirlmere, south of Leonard St facing south.
- 2) Thirlmere Way Thirlmere, south of QV roundabout facing north.
- 3) Oaks St Thirlmere, west of Victoria St intersection facing west
- 4) West Pde Thirlmere, north of Chanter St, facing south.

All roads to be closed for this community event are controlled by the Wollondilly Shire Council.

Twenty one (21) days prior to the festival direct mail will be sent to all properties within the event zone and the neighbouring areas advising of these times & conditions of road closure

12.0 Emergency Vehicles

All areas of the Thirlmere Festival of Steam will be accessible to emergency vehicles. Each road closed and barricade will be crewed by trained personnel able to assist in the event of emergency vehicle requiring access. Emergency vehicles shall be directed to the nearest entry to the emergency to allow minimal effect on the pedestrian traffic.

13.0 Timing of the event including set up & pack up

The road closures will be starting at 6am. This will be the Stage 1 Bump In. Larger stalls utilising trucks & large trailers will be invited to set up between 6am & 7am.

Stage 2 Bump In - 7am to 8am is offered to smaller stalls to setup their marquees and exhibits.

Vintage cars are invited to display from 8.30 am, entering the precinct via Westbourne Ave north end only.

Large Steam Machines are set up on Rail Museum site the day prior to the event.

Amusement Rides are set up on Thirlmere School site the day prior to the event.

Dumpsters, Otto bins & port-a-loos are set up on the day prior to the event.

1 tent is set up in Memorial Park on the day prior to the event.

Public access will commence from 9am and continue until 4pm. At 4pm the event will close. Bump out stage will commence approx. 4.00pm with all stalls and exhibitions removed and roads opened at 5pm. In the event of identified safety issues, bump out will be controlled accordingly by WSC traffic manager.



TRAFFIC MANAGEMENT PLAN THIRLMERE FESTIVAL OF STEAM 2020



14.0 Traffic Controllers

WSC Traffic Specialist, Shannon Thomas, on site as Traffic Supervisor in conjunction with RFS to control all traffic management including detours, issues, risks and controls on the days of the festival.

RMS accredited traffic controllers will be responsible for, implementing the traffic management procedures and devices as described in this plan, and monitoring traffic flow on public roads affected by the works undertaken within the scope.

Traffic Supervisor
Contact: Shannon Thomas
Mobile: 0419 613 668

15.0 OHS & R

Shannon Thomas will assess the Traffic Risk Management within & outside the Festival precinct and will develop a Job Safety and Environmental Analysis (JSEA) prior to conducting any works associated with the identified hazard. All persons involved in the work will be inducted into the safe work method and JSEA.

BD Productions will assess Risk Management matters within the precinct relevant to Stalls & Rides.



TRAFFIC MANAGEMENT PLAN
THIRLMERE FESTIVAL OF STEAM 2020



Locality & town maps - showing Park & Ride stops, parking

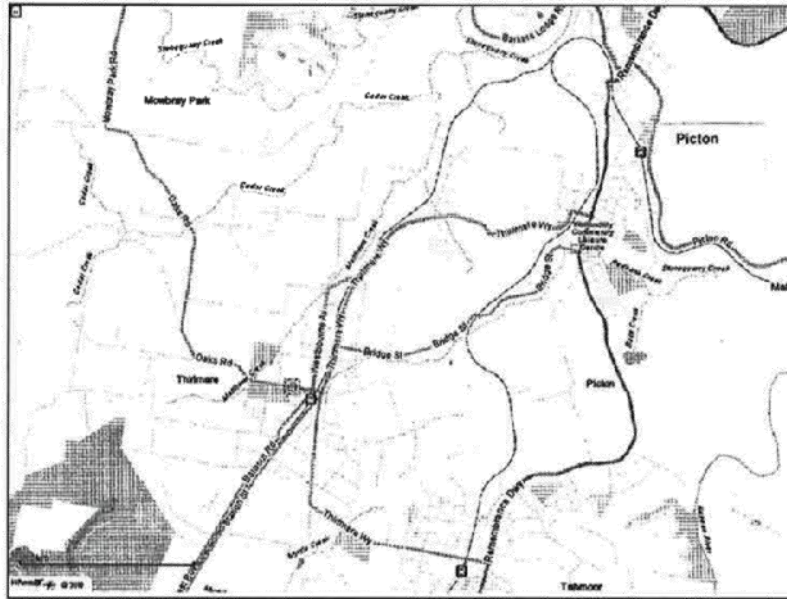

THIRLMERE MAP





TRAFFIC MANAGEMENT PLAN
THIRLMERE FESTIVAL OF STEAM 2020



TAHMOOR MAP

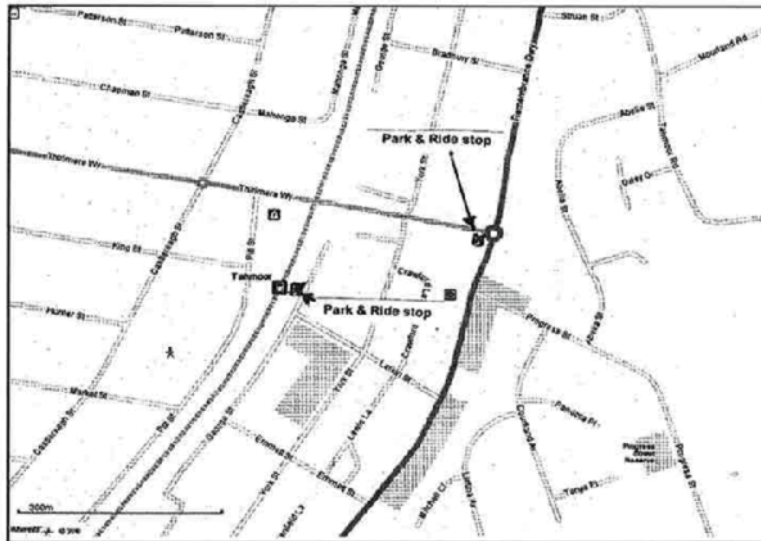

TRAFFIC MANAGEMENT PLAN
THIRLMERE FESTIVAL OF STEAM

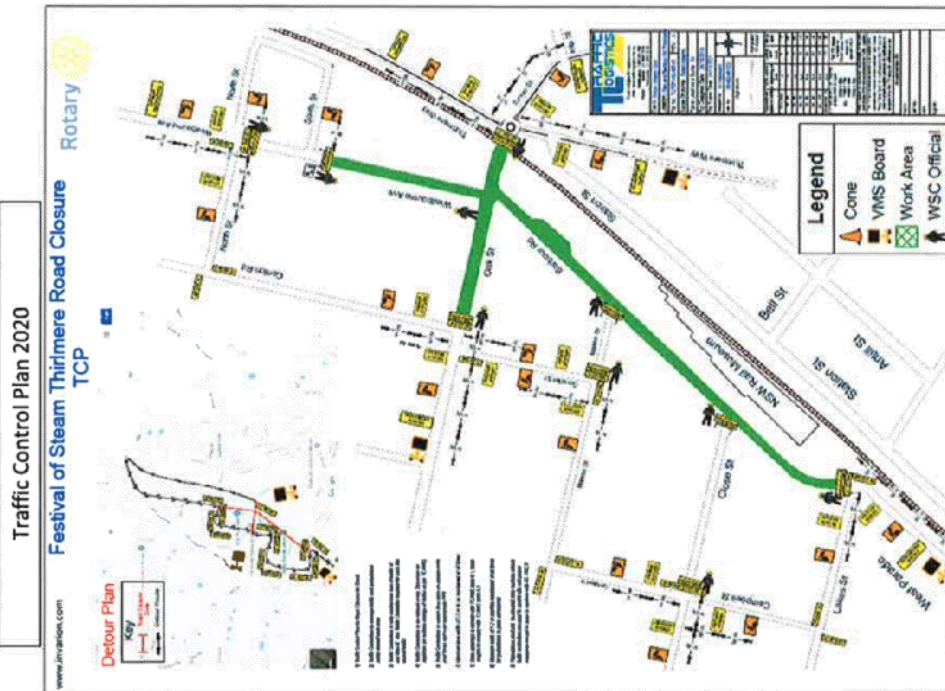

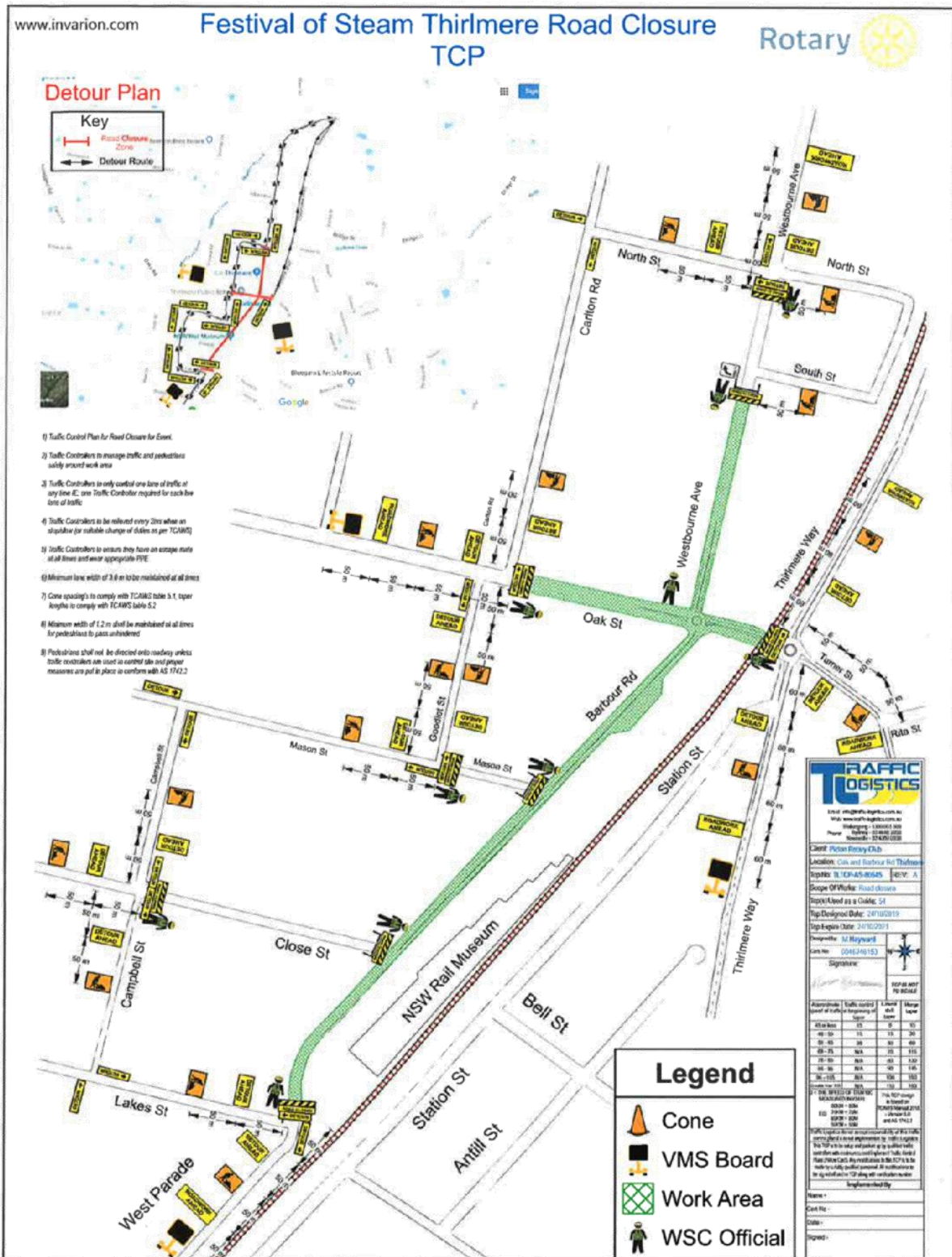

2 GENERAL BUSINESS

2.1 DOUGLAS PARK DRIVE SLOPE STABILISATION WORK AND TEMPORARY ROAD CLOSURE

File Number: 10623#91

EXECUTIVE SUMMARY

- The purpose of this report is to inform the Local Traffic Committee of the upcoming Council Project – Douglas Park Drive Slope Stabilisation which requires a temporary road closure of a section of Douglas Park Drive for the duration of nine weeks.

REPORT

- In response to a recent Geotechnical investigation report commissioned by Council, essential rectification works will be carried out by a Council appointed contractor to mitigate hazards along the cliff line and up-slope of Douglas Park Drive between the junction of Moreton Park Rd and the causeway.
- The project duration is nine weeks and will require a full road closure during this period. It is proposed to close Douglas Park Drive from the junction of Moreton Park Rd to the top of the southern gorge utilising the existing emergency road closure gates.
- Public notifications and detours will be announced 28 days prior to the road closure by WSC Communications Team in the form of Council website and local media. Variable message boards and detour signage will be installed before, and during the road closure.
- Local residents and all emergency services will be given advanced notice prior to the closure.

ATTACHMENTS

- | | | | |
|----------------------------|----------|---|-----|
| 1. Detour Plan | | | |
| 2. TCP 1 - Traffic Control | | | |
| 3. TCP 2 - Road Closure | | | |
| 4. Traffic | Planning | - | RFI |

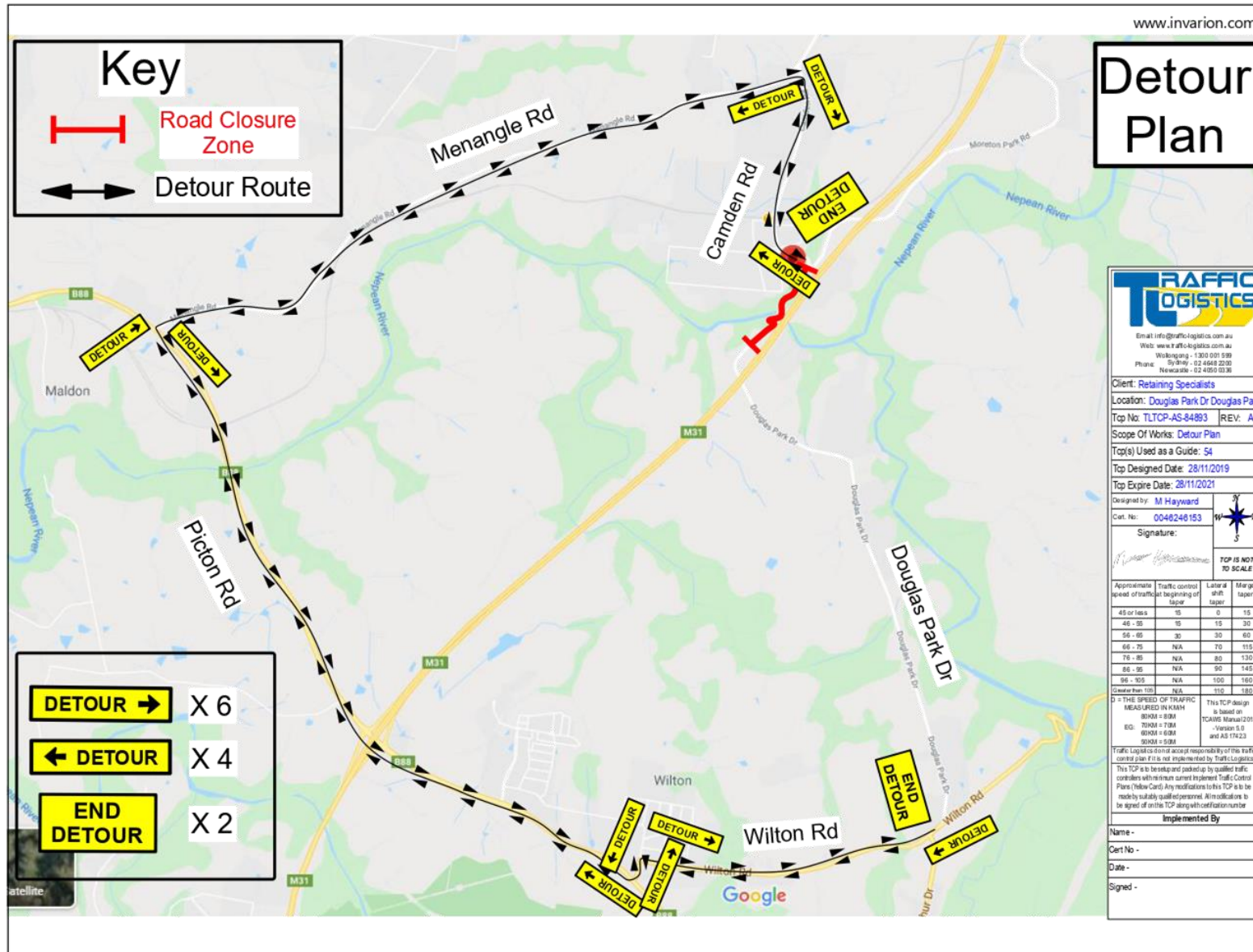



Retaining Specialists
Be Sure Be Successful

Douglas Park Drive Douglas Park Stop Slow TCP

www.invarion.com

Note
Sign pushed back Before bends with repeat flagman on safe location at wide bend.



Work Location



Legend

- Cone
- Work Area

1) Traffic Control Plan for Stops and Stop Slow
 2) Traffic Controllers to manage traffic and pedestrians safely around work area
 3) Traffic Controllers to only control one lane of traffic at any time. E: one Traffic Controller required for each live lane of traffic
 4) Traffic Controllers to be relieved every 2hrs when on stop/slow (or suitable change of duties as per TCAWS)
 5) Traffic Controllers to ensure they have an escape route at all times and wear appropriate PPE
 6) Minimum lane width of 3.0m to be maintained at all times
 7) Cone spacings to comply with TCAWS table 5.1, taper lengths to comply with TCAWS table 5.2
 8) Minimum width of 1.2m shall be maintained at all times for pedestrians to pass unhindered
 9) Pedestrians shall not be directed onto roadway unless traffic controllers are used to control site and proper measures are put in place to conform with AS 1742.3

North End



Middle



South End



Nepean River



Stop Slow Zone



Implemented By

Name -
 Cert No -
 Date -
 Signed -

TRAFFIC LOGISTICS

Email: info@trafficlogistics.com.au
 Web: www.trafficlogistics.com.au
 Wagga Wagga - 1300 631 188
 Sydney - 02 4688 2200
 Newcastle - 02 4950 0336

Client: Retaining Specialists
 Location: Douglas Park Dr Douglas Park
 Top No: TLTCP-AS-84892 REV: A
 Scope Of Works: Stop Slow
 Top(s) Used as a Guide: 84
 Top Designed Date: 28/11/2019
 Top Expire Date: 28/11/2021
 Designed by: M Hayward
 Cert No: 0046248153
 Signature: _____
 TCP IS NOT TO SCALE

Approximate speed of traffic at beginning of taper	Traffic cone or sign at beginning of taper	Lateral shift at taper	Merge taper
45 or less	15	0	15
46 - 55	15	15	30
56 - 65	30	30	60
66 - 75	N/A	70	115
76 - 85	N/A	80	130
86 - 95	N/A	90	145
96 - 105	N/A	100	160
Greater than 105	N/A	110	190

D = THE SPEED OF TRAFFIC MEASURED IN KM/H
 90KM = 90M
 70KM = 70M
 60KM = 60M
 50KM = 50M

This TCP design is based on TCAWS Manual 2019 - Version 5.0 and AS 1742.3

Traffic Logistics do not accept responsibility of this traffic control plan if it is not implemented by Traffic Logistics. This TCP is a design and packed by qualified traffic controllers with minimum current Inspec Traffic Control Plans (Yellow Card). Any modifications to the TCP is to be made by suitably qualified personnel. All modifications to be signed off on the TCP along with certificate number.



Retaining Specialists
Be Sure Be Successful

Douglas Park Drive Douglas Park Road Closure TCP

www.invarion.com



Work Location

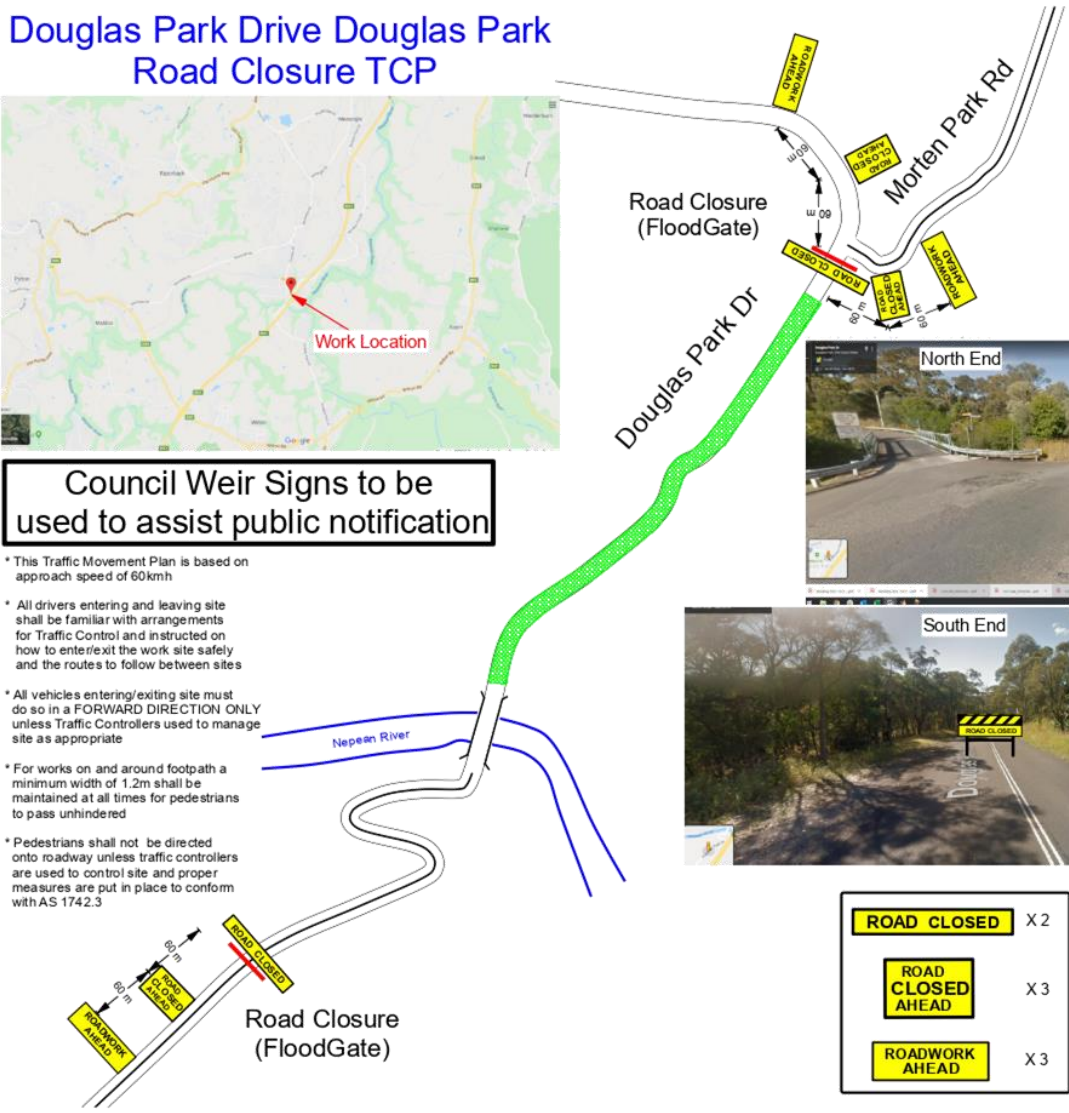

Council Weir Signs to be used to assist public notification

- * This Traffic Movement Plan is based on approach speed of 60kmh
- * All drivers entering and leaving site shall be familiar with arrangements for Traffic Control and instructed on how to enter/exit the work site safely and the routes to follow between sites
- * All vehicles entering/exiting site must do so in a FORWARD DIRECTION ONLY unless Traffic Controllers used to manage site as appropriate
- * For works on and around footpath a minimum width of 1.2m shall be maintained at all times for pedestrians to pass unhindered
- * Pedestrians shall not be directed onto roadway unless traffic controllers are used to control site and proper measures are put in place to conform with AS 1742.3

Approximate speed of traffic	Traffic control beginning of taper	Lateral shift	Merge taper
45 or less	15	0	15
46 - 55	15	15	30
56 - 65	30	30	60
66 - 75	N/A	70	115
76 - 85	N/A	80	130
86 - 95	N/A	90	145
96 - 105	N/A	100	160
Greater than 105	N/A	110	180

D= THE SPEED OF TRAFFIC MEASURED IN KMH
E.G. 70KM = 70M
80KM = 80M
90KM = 90M
100KM = 100M

This TCP design is based on TCAMS Manual 2018 - Version 5.0 and AS 1742.3

Traffic Logistics does not accept responsibility of this traffic control plan if it is not implemented by Traffic Logistics

This TCP is to be setup and packed up by qualified traffic controllers with minimum current implement Traffic Control Plans (Yellow Card). Any modifications to this TCP is to be made by suitably qualified personnel. All modifications to be signed off on this TCP with verification number

Implemented By

Name - _____

Cert No - _____

Date - _____

Signed - _____



North End



South End

ROAD CLOSED

X 2

ROAD CLOSED AHEAD

X 3

ROADWORK AHEAD

X 3

Request for Information (RFI)



Project No.:	1819495: 2019/18 Douglas Park Drive Slope Stabilisation	RFI #:	1819495 - DM RFI 03
Date sent:	21/11/19	Date Required:	5/12/19
Submitted To:	Mitchell Keats	Submitted By:	Neal McQuade
Subject:	Traffic Planning for Notifications	Drawing No.:	N/A
Cost Impact:	\$ NIL	Location:	DPD
RFI must be assessed to determine if there is an impact on risk to safety and environment.		Safety Assessment required?	Yes / No If yes, attach a copy.

Information Requested:

INTERNAL PLANNING FOR THE ROAD CLOSURES AT DPD

Suitability Tests

Drilling & Installing, 13/12.

- will require stop/slow
- planned duration approx. 9am -4pm

Load testing, 17/12.

- will require stop/slow
- planned duration approx. 9am -4pm

Works Proper

- Full road closure, intersection w/ Moreton Park Road to DPD Weir (allowing public access to Nepean River).

Noted

- If no work is planned on weekends, would opening on weekends be manageable or pose too many risks and issues?

NOT feasible, lots of big equipment and dirt to move, basically take most of Monday & Friday each week to mobilise and remobilise, plus site may be in a temporary unsafe state.

Draft TCPs & Compound Set-out

Please find attached for your review:

- draft copies of TCPs for stop-slow and full road closure with detour plan, and,
- insert of site set-out with compound.

	Neal McQuade	Signature:	
--	--------------	-------------------	--

Response

Please provide comment or respond with instructions to proceed.

Answered by:	Signature:	Date:
---------------------	-------------------	--------------

Document	Date	Version #	Review Date	Approved By
Request for Information	30/4/19	V1.0	30/4/2021	Neal McQuade

Request for Information (RFI)



Other Background Information

Attachments:

1. TLTCP-AS-84892 REV A Douglas Park Drive Douglas Park Stop Slow TCP
2. TLTCP-AS-84893 REV A Douglas Park Drive Douglas Park Road Closure TCP
3. Detour Plan TCP

1819 495 Wollondilly – Compound & Site Location

Vehicles >3T access site from northern entrance to Douglas Park Drive.



Page 2 of 2

Document	Date	Version #	Review Date	Approved By
Request for Information	30/4/19	V1.0	30/4/2021	Neal McQuade