

LOCAL TRAFFIC COMMITTEE

Minutes of Out of Session Meeting
held electronically on
Wednesday 19 April 2017

WOLLONDILLY SHIRE COUNCIL

ELECTRONIC DISTRIBUTION LIST

Voting Members

Clr Judith Hannan

Clr Robert Khan

Clr Blair Briggs

Jai Rowell

Jayd Marsh

Sergeant Marcus Cotton

Snr Const Stephen Page

Snr Const Mick Tanner

Mayor - Wollondilly Shire Council

Deputy Mayor - Wollondilly Shire Council

Alternate Delegate - Wollondilly Shire Council

State MP

Roads and Maritime Services (RMS)

Campbelltown Police (Appin)

St Marys Police (Warragamba/Silverdale)

Camden Police

Other Members

Chris Moule

Steve Grady

Steve Burrige

Robert Yianakis

Merlinda Hyde

Picton Buslines

Busways

Busabout

Busabout

Busabout

Wollondilly Shire Council Staff

Michael Nelson

Norma Toweel

Ian Berthon

Choong Yam

Tracey Collier

Manager - Infrastructure Planning

Acting Infrastructure Coordinator

Investigation & Design Engineer

Senior Traffic Engineer

Administrative Support

All other Councillors

All other Executive

RESPONSES RECEIVED

Clr Judith Hannan

Snr Const Mick Tanner

Jayd Marsh

ITEMS DISCUSSED

All items were moved concurrently.

Resolved unanimously by the committee:

That Council resolve to adopt the Recommendations of the Local Traffic as follows:

1. **Proposed line marking modification on Wilton Road**

52

Trim #1598

EXECUTIVE SUMMARY

Request to implement line marking modifications along a section of Wilton Road.

REPORT

Council has recently reviewed the longitudinal centre line marking for section of Wilton Road from Douglas Park Drive junction to Broughton Pass. Section of the existing line marking is not in accordance with Australian Standard 1742.2 and need to be modified accordingly. The line marking changes would improve road safety along this section of Wilton Road.

CONSULTATION

This issue has not been raised and discussed in a Community Forum

ATTACHMENTS:

1. Aerial photo showing the proposed line marking modifications.

RECOMMENDATION

That Council endorse the line marking modifications on section of Wilton Road as shown in the attachment of this report.

The modification works to be listed in the Infrastructure Projects list for implementation.

Action: No objection.

On Wilton Road from east of junction with Douglas Park Dr to Broughton Pass.



2.

Proposed line marking modification on Burragorang Road

52

Trim #1598

EXECUTIVE SUMMARY

Request to implement line marking modifications along sections of Burragorang Road.

REPORT

Council has recently reviewed the longitudinal centre line marking for the length of Burragorang Road. Sections of the existing line marking are not in accordance with Australian Standard 1742.2 and need to be modified accordingly. The line marking changes would improve road safety along the length of Burragorang Road.

CONSULTATION

This issue has not been raised and discussed in a Community Forum.

ATTACHMENTS:

2. Aerial photos showing the proposed line marking modifications.

RECOMMENDATION

That Council endorse the line marking modifications on Burragorang Road as shown in the attachment of this report.

The modification works to be listed in the Infrastructure Deferred Projects list for consideration in Council's Management Plan (Budget).

Action: No objection.

On Burragorang Road at junction with Janette Place



On Burragorang Road at west of junction with Acacia Avenue.

ATTACHMENT 2



On Burragorang Road at No. 1775.

ATTACHMENT 2



On Burragorang Road just north of No 1840



On Burragorang Road at 800m north of No 1840



3. **Proposed line marking modification on Barkers Lodge Road**

52

Trim #1598

EXECUTIVE SUMMARY

Request to implement line marking modifications along the length of Barkers Lodge Road.

REPORT

Council has recently reviewed the longitudinal centre line marking for the length of Barkers Lodge Road. Sections of the existing line marking are not in accordance with Australian Standard 1742.2 and need to be modified accordingly. The line marking changes would improve road safety along the length of Barkers Lodge Road.

CONSULTATION

This issue has not been raised and discussed in a Community Forum.

ATTACHMENTS:

3. Aerial photos showing the proposed line marking modifications.

RECOMMENDATION

That Council endorse the line marking modifications on Barkers lodge Road as shown in the attachment of this report.

The modification works to be listed in the Infrastructure Deferred Projects list for consideration in Council's Management Plan (Budget).

Action: No objection.

On Barkers Lodge Road at junction with Abbotsford Road.



On Barkers Lodge Road at junction with Rays Lane.



On Barkers Lodge Road at junction with Mowbray Park Road.



On Barkers Lodge Road at junction with Fergusson Road





On Barkers Lodge Road just south of junction with Halliday Road.

ATTACHMENT 3



On Barkers Lodge Road just north of junction with Sheehys Creek Road.



On Barkers Lodge Road at junction with Russell Lane

ATTACHMENT 3



General Business

Council

Council has received a notification as a consent condition of an extended DA approval for a Special Event (Obstacle Course Event – “Spartan Race”) to be held on 6 May 2017 at a Recreation Facility off Picton Road (MR 612). This event obtained a rolling Council approval up to 2019.

The event will attract high traffic volumes over the period with anticipated number of participants (4500 participants + 2000 spectators) and has the potential to create adverse road safety and traffic impact on Picton Road.

The event is classified as “Class 1 special event” under the “Guide to Traffic and Transport Management for Special Events”

The applicant has prepared a Traffic & Transport Management Plan, Risk Assessment Report and Event Management Plan & Statement of Environmental Effect as part of the DA consent condition.

As the event is classified as “Class 1 special event” under the “Guide to Traffic and Transport Management for Special Events” and the traffic Impact is on classified road (Picton Road – MR612), it is the Roads and Maritime Services (RMS) responsibility to decide what conditions to impose as well as Police concurrence.

ATTACHMENTS:

4. Traffic & Transport Management Plan

COMMENTS:

RMS have the following concerns in relation to the Spartan Race Event:

- ROL 738160 applied for 6th May 17 Only and with no time range.
- Event proponent to confirm if the same traffic control will be applied for Hurricane Heat event on 7th May 17.
- Public liability insurance – not received.
- Police and LTC concurrence – to be provided.
- Updated Road Occupancy License – To be provided.
- VMS messaging details prior to the event day – to be provided.
- Updated TCP – to be provided.

Transport & Traffic Management Plan



Spartan Race Sydney Sprint/Beast

Venue: 245 Picton Rd, Razorback Date:
Saturday 6th May 2017

**Spartan Race Australia
Initiative Events Pty Ltd**
ABN 27 616 039 797
14 March 2017

1 General Information

1.1 Purpose

The purpose of this Traffic Management Plan strategy (TMP) is to assess the traffic and parking implications of the Spartan Race event and identify elements required for the safe conduct of the event on Saturday 6th May 2017 at 245 Picton Road, Razorback, NSW (the venue).

This document will provide background information and an adequate and consistent strategy that describes the plans required to control and facilitate the management of Traffic, Access, Parking and Transport movements external to the venue during the various phases of Event Operations. The TMP focuses on the requirements for the flow of traffic during the bump in, event operation, and bump out phases and the proposed treatments to minimise disruptions to the non-event community and a smooth running of the event.

1.2 Organisational Context

This TMP is part of the planning documentation submitted to Wollondilly Shire Council as part of the event planning requirements, and must be read in conjunction with other documentation and information supplied by Spartan.

1.5 Event Overview continued ...

Spartan is a Commercial Adventure Event – Classified as a minor outdoor event

Proposed Attendance: 4,000 participants & spectators overall

Demographic: Male and Female 5yrs – 50yrs, target demographic

Gates Open: 6th May 6:00am

Concludes: 6th May 6:00pm

Event Transportation: Private Vehicle, Public Transport

Lane & Road Closures: No lane or road closures being proposed

Special Event Clearways: Nil Identified

Speed zone application (SZA): Reduce speed from 100km/h and 80km/h to 60km/h

Message on Spartan web site: 'NO Parking on Picton Rd, parking infringements will be issued'

Temporary Taxi Ranks: Space to be made available for drop-off & pick-ups

Event Car Parking: On-site managed by Spartan; parking on grassed areas, within event site, at \$10/ vehicle. Parking Estimate up to 1,500 -1,600 vehicles may arrive on site.

Capacity: 2,000 vehicles (untreated grassed car park)

Private Vehicle Set-down: Space to be made available for drop-off & pick-ups

Initiative Events/Spartan Race Australia is the producer and promoter of the event:-

Promotion, Marketing; Production on site; Risk Assessment & Management; Environmental Impacts; Insurances by Spartan

Updated information at <http://spartanrace.com.au/race-info>

1.6 Event Site—245 Picton Rd, Razorback (Picton) NSW

The event site is located approximately 5 kilometres by road from Picton town centre (via Menangle Street - Picton Road), and a similar distance from the Picton Road interchange of the M31 Hume freeway Wilton. Vehicular access to "The Ranch," 245 Picton Rd., is off Picton Road (opposite the go-kart track) and close to the Maldon Bridge Rd roundabout, with an internal access road providing access between Picton Road and the event area, which is about 300m from the Picton Road access.



4.1 Overview of Traffic Management Strategy

The Traffic Management Plan provides a Vehicle Movement Plan (VMP) to show the ingress of event participants, staff and event day contractors. It also details the cross over between ingress and egress from the site as the morning starters begin leaving the event.

The internal car parking will be managed by grey card or higher certified event marshals, to facilitate the movement of vehicles smoothly to parking locations on the site.

The staggered nature of the participant wave start system will minimise peak traffic volumes and traffic congestion.

4.2 TMP Operations

The design of the TCPs has been based on, advanced notifications and messages, clear signage and minimal devices resulting in a self managed control system of vehicles at a road speed which can tolerate the various movements of vehicles through this section of road.

The speed limit will be reduced to allow traffic controllers to assist with traffic flow at peak times in the event ingress or egress should queuing to the event site begin to occur. Once the queues have been cleared entry/exit to the site will return to normal road operations.

4.3 Traffic Control Plans

4.3.1 Overview of Traffic Control Plan No 1:

Picton Rd between Menangle Rd and 400m to the west of Maldon Bridge Rd, including Maldon Bridge Rd/ Picton Rd intersection and 245 Picton Rd access roadway.

4.4 Overview of Traffic Management Plans

- No Special Event Clearways required
- No road or lane closures required
- No Temporary No Stopping Signs required
- A full list of all Traffic Control devices and signage will be included in final TMP
- A Speed Reduction Zone is required and a SZA must be lodged with RMS for the section of Picton Road between Maldon Bridge Road and Menangle Road. Speed reduced from 100km/h westbound and 80km/h eastbound to 60km/h both directions.

4.5 ROL

An ROL will be submitted to RMS as a notification about the event, even though there are no lane or road closures.

4.6 Police Deployment

Camden LAC will determine if Police may need to be deployed to the site through their own risk management process.

It is not envisaged that the TMP would require dedicated Police resources on point.

4.7 RMS Involvement in Implementation

No additional involvement of RMS resources have currently been identified or included for the implementation of the TMP.

4.8 Local Council Involvement in Implementation

No additional involvement of Wollondilly Shire Council resources have currently been identified or included for the implementation of the TMP.

4.9 Internal Venue / Event Signage

Additional Parking, access, pedestrian, transport, directional, instructional signage will be installed in areas used for parking and areas / sites used by the event.

4.10 External Venue / Event Signage – Static Signage

Limited external event signage will be required. Use of Static signs would be an advantage to inform participants of where to enter for parking to the site, clear signage to the event site may assist minimise confusion and allow for consistent vehicle flows. VMS boards will be used as advanced notification to drivers approaching the site from the east and west.

4.11 Variable Message Signs (VMS)

Variable Message Signs (VMS) will be utilised at two locations to assist with navigation to the site and to provide advanced warning. They will be installed from 1 week prior to the event, for advanced notification messages about the event.

4.11.1 VMS 1 Message

Frame 1:	Frame 2:
EVENT	MAKE
PARKING	U-TURN @
1KM AHEAD	ROUNDABOUT

4.11.2 VMS 2 Message

Frame 1:	Frame 2:
EVENT	ON LEFT
PARKING	DELAYS
1KM AHEAD	EXPECTED

4.12 Emergency Access Corridors and Procedures

Emergency access will be maintained into and out of the site at all times during all phases of

the event. The internal parking plan will show how an emergency route must be maintained at all times from Picton Rd to the event site & First Aid area.

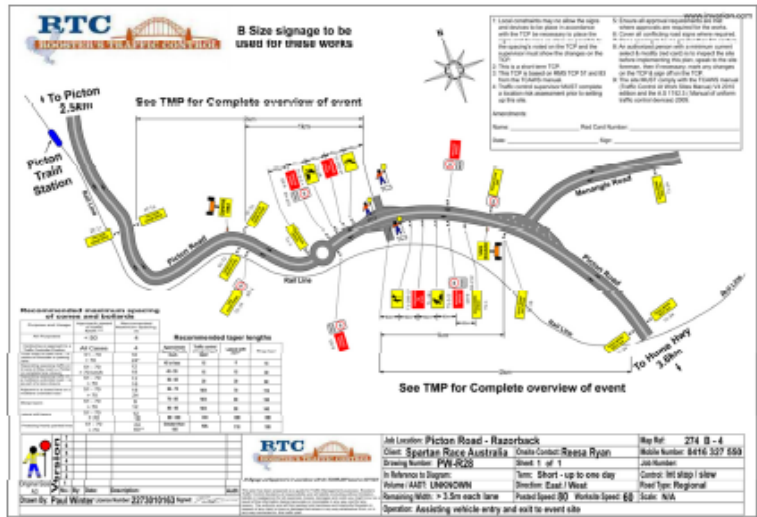

RMS REPORT

No issues to report

POLICE REPORT

No issues to report

CLOSING

There being no further business, the Local Traffic Meeting was declared closed.